

# ALBERTSON'S ANCHORED NEIGHBORHOOD CENTER

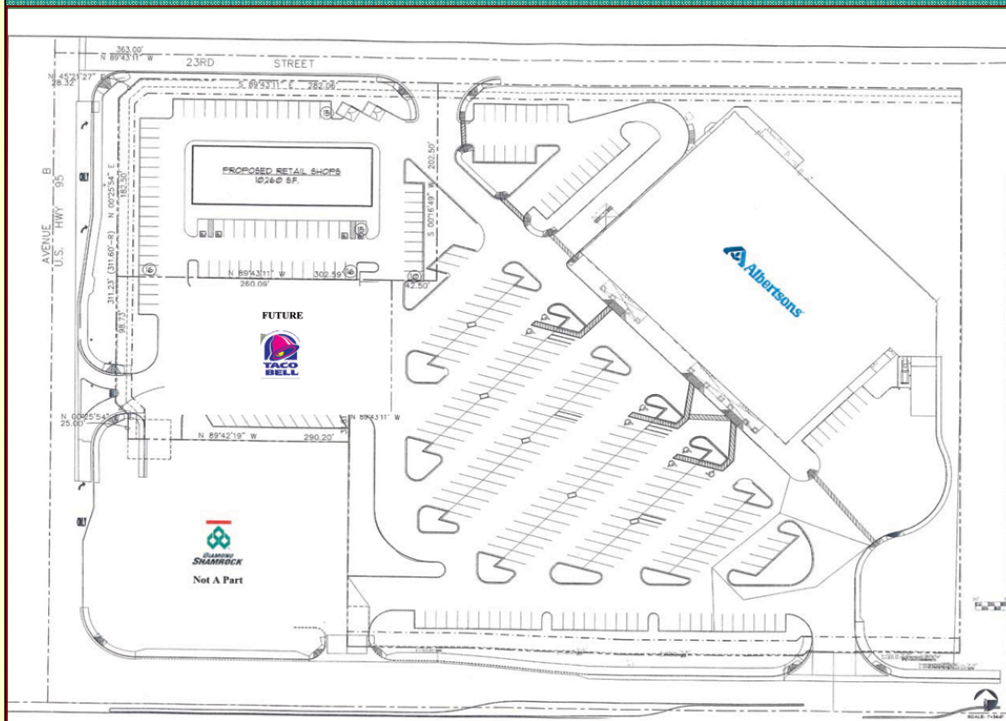

NEC 24<sup>th</sup> Street & Avenue B  
Yuma, Arizona

~~The project is located in one of the busiest and fastest growing trade areas in Yuma, and is across the street from a 30 acre Super Wal Mart Center (2005 Opening). Albertson's is now open for business and the retail shops will break ground in the summer or 2006. Pads include Diamond Shamrock Gas (not included) and Taco Bell (2006)~~

